

□ 254 Axial fan
× 89mm



■ General Specifications

- Motor : Singal phase induction capacitor motor
- Frame & Impller :Al Die-casting & PBT plsatic
- Storage temperature : -40°C to +75°C
- Operating temperature : -10°C to +60°C

■ Major Characteristic Parameters

品牌	轴承	电压	频率	功率	转速	风量	静压	噪音		
型号	B/S	V	HZ	W	RPM	m3/mi n	CFM	mm-H2O	In-H2O	dba
SP250B11H-90AL	B / S	110	50/60	60/67	2150/2000	24.5/22.8	700/630	7.9/8.7	0.31/0.35	56.0
SP250B22H-90AL	B / S	220	50/60	60/67	2150/2000	24.5/22.8	700/630	7.9/8.7	0.31/0.35	56.0
SP250B11H-90AT	B / S	110	50/60	60/67	1400/1600	24.5/22.8	700/630	7.9/8.7	0.31/0.35	56.0
SP250B22H-90AT	B / S	220	50/60	60/67	1400/1600	24.5/22.8	700/630	7.9/8.7	0.31/0.35	56.0

*Bearing system B: Two Ball Bearing S: Sleeve Bearing

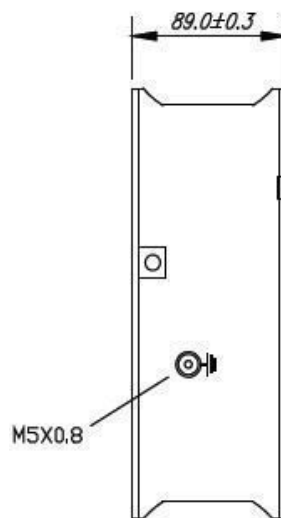
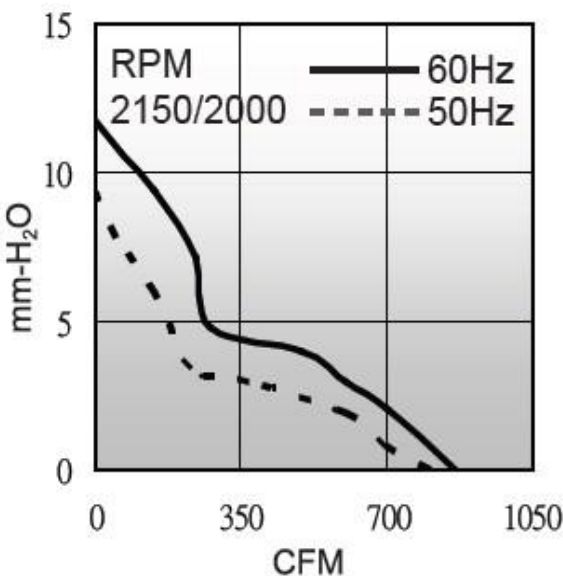

unit:mm

